



ZIPPITY

Easy Does It!

BASKENRIDGE VINYL GATE KIT W/ FENCE WINGS (51 $\frac{3}{8}$ "W X 36"H)

ASSEMBLY INSTRUCTIONS ZP19038

60 MIN

Approximate assembly time

Want to see a video on how to
assemble this product?
Scan the QR code

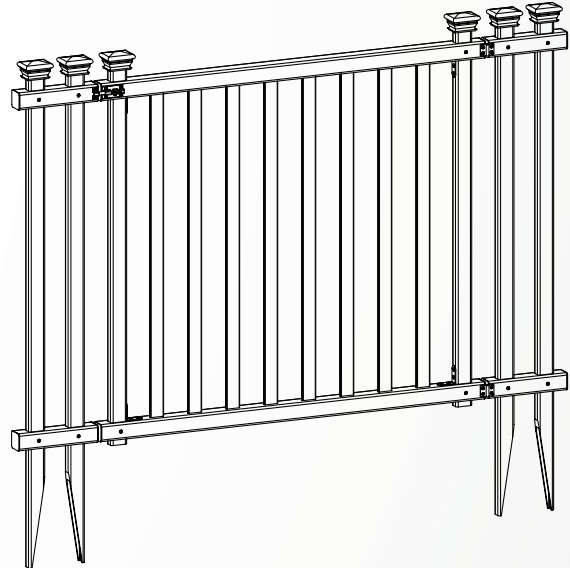

GENERAL INFORMATION



IMPORTANT

- + Check the inside of the larger pieces in your box for other materials packed inside.
- + When assembling components, place on a non-abrasive surface (i.e. shipping box) to avoid scratching.
- + We recommend an area approximately 5'x 8' for unobstructed assembling.
- + You should not need to use excessive force when assembling components.

MISSING OR DAMAGED PARTS?

VISIT OUR WEBSITE FIRST, SO WE CAN HELP YOU RIGHT AWAY!

Although great care has been taken to ensure proper packaging and handling of this product, occasionally problems occur. If you discover any missing, damaged or defective parts, please visit our website to order replacement parts. If you experience any further trouble with your product, please contact our customer service department.

 parts.nychbrands.com

 support@zippity-outdoor.com

 **704-892-5222 / 877-234-6196**

Customer service agents are available to take calls weekdays from 9am-5pm EST. If you call outside of business hours, please leave a voicemail.

To help you quickly and accurately, please have reference item number **ZP19038** and the specific part name which can be found on page 5. It is helpful if you can provide the batch lot which is a stamped number on the inside of the box.

NEED ASSEMBLY HELP?

If you are having problems with the assembly or installation of this product, we are happy to assist you with the process, **so please give us a call at 704-892-5222 / 877-234-6196.**

NEED TO RETURN?

If for some reason you need to return this product, please allow us to help resolve your issues first. If you still decide to return the product, **you will need to initiate the return from the company you originally purchased from.**

GENERAL INFORMATION

1. Read over fence instructions first.

Your gate and fence will work better together if you first take the time to read and understand your fence.

2. Pre-assemble the gate frame.

Please do not screw the gate frame together until you have temporarily assembled the gate frame. In other words, do a dry run first. This will ensure:

1. That you have everything necessary to complete the gate.
2. That you will have assembled the gate frame in the correct order.
3. All of the pieces fit and function properly.
4. The gate height and width are similar to the measurements shown on page four.

It's easier to troubleshoot when things are not screwed together. After you assemble your gate correctly, please disassemble as necessary, and use the provided self-drilling stainless steel screws to permanently assemble the gate.

3. Install your gate posts before your fence posts.

Your fence panels will be more forgiving for a custom fit than your gate. Position and install your gate posts before you do anything else.

4. Do not hang your gate system off a single non-supported post.

Your gate will perform better and last longer if your hinge post is connected to a panel of fence that is connected to another post. This way, the weight strain will be transferred onto two posts versus just one. Installing fence panels on both sides of your gate is ideal in all situations. If this is not possible because of space restrictions, please contact us for alternative solutions.

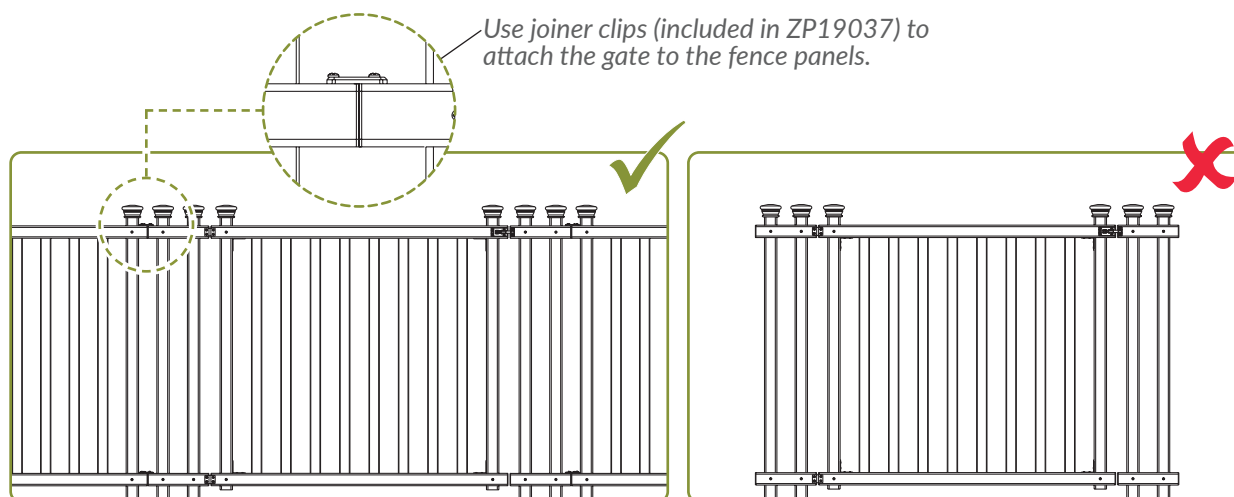

Dimensions and Specifications

Baskenridge Vinyl Gate Kit w/ Fence Wings (51 $\frac{3}{8}$ " W x 36" H)

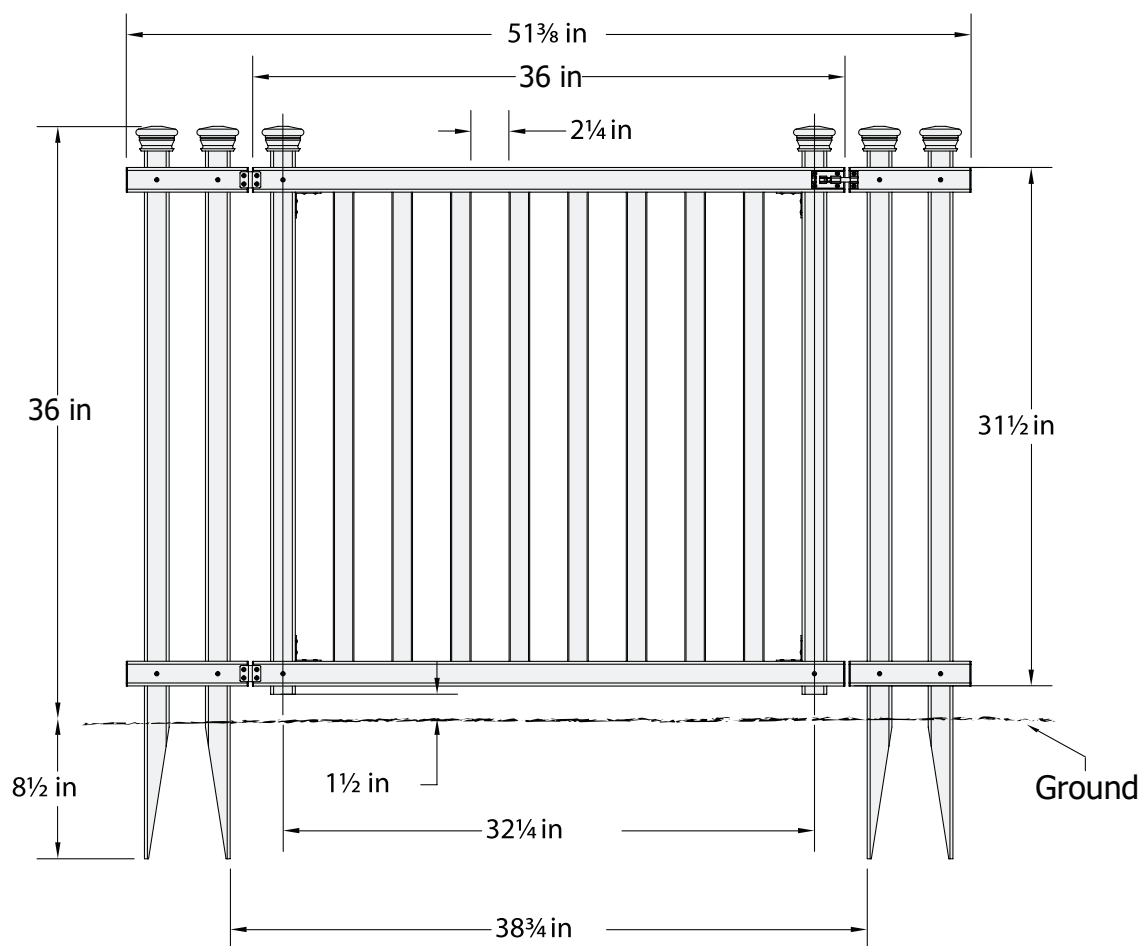

STEP 1: UNPACK MATERIALS

STEP 1.1 ►

- Check the inside of larger pieces in your box for other materials packed inside.

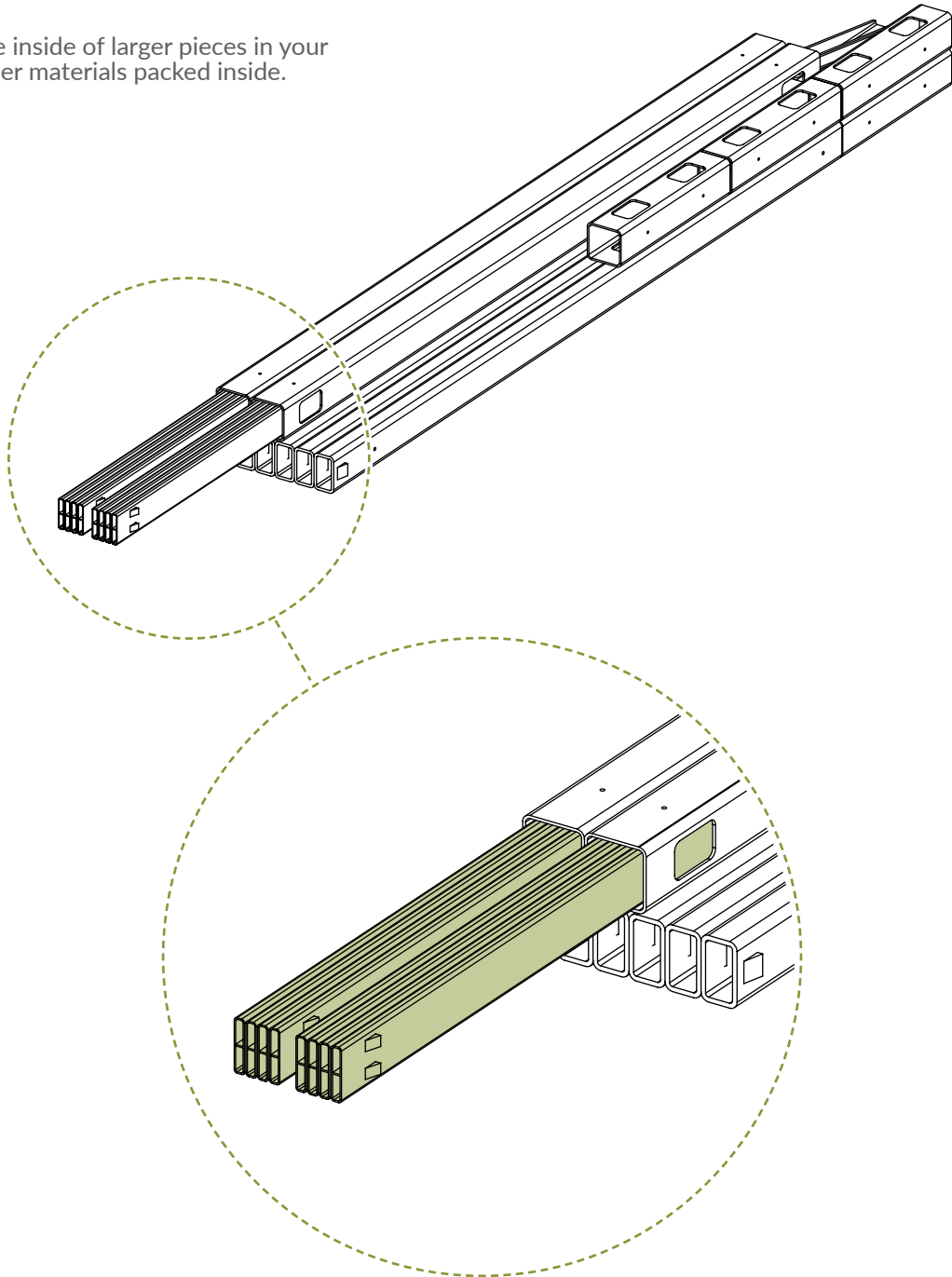

STEP 2: LAY OUT TOOLS

► Tools required for a smoother installation experience.

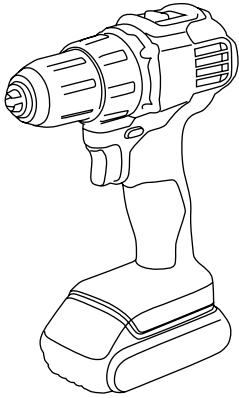

► Drill

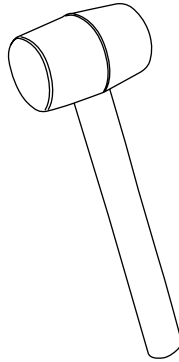

► Mallet*

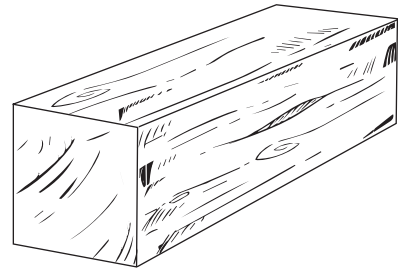

► Wood Block*

*- May be needed depending on soil condition

OPTIONAL

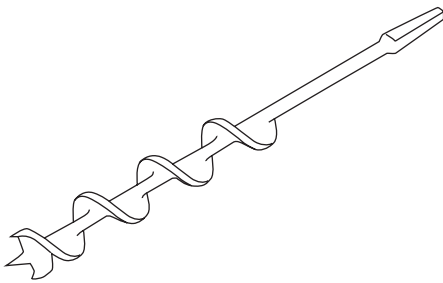

► 1 1/4" Tulip Auger *

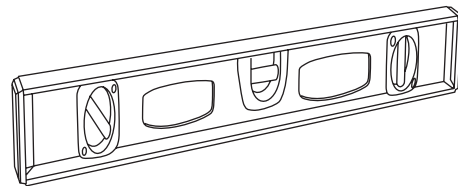

► Level

*- May be needed depending on soil condition

STEP 3: LAY OUT MATERIALS

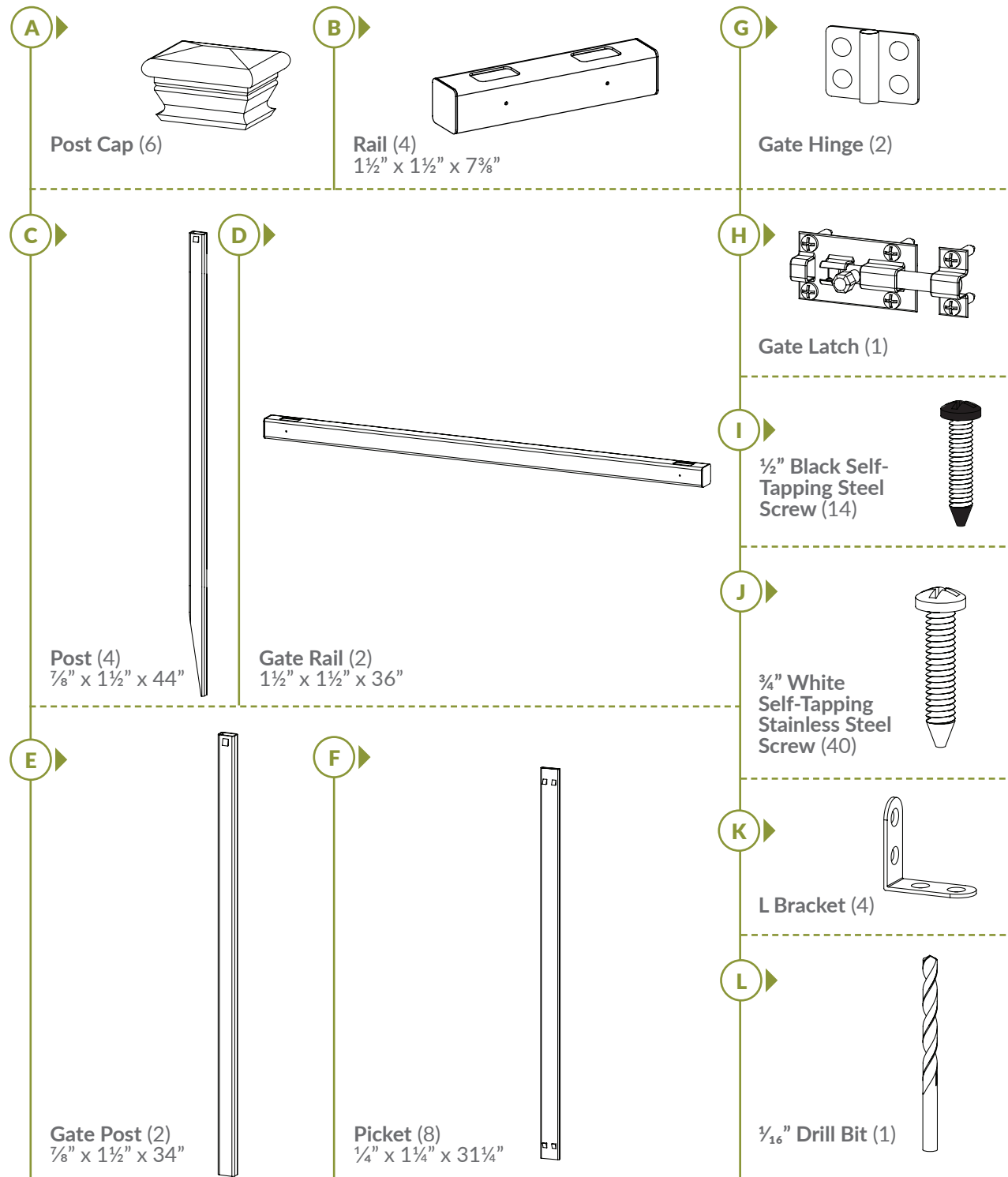

STEP 4: ASSEMBLE GATE FRAME

STEP 4.1 ▶

- Orient the Gate Posts (E) so the tabs are facing up as illustrated. Insert the gate posts down through (1) Gate Rail (D).

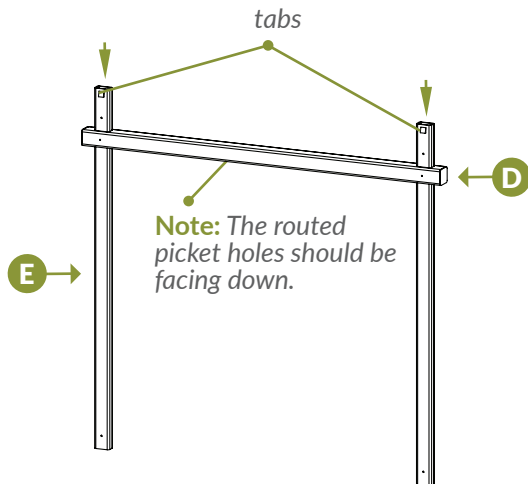

STEP 4.2 ▶

- Align the pre-drilled holes in the gate rail with the pre-drilled holes in the gate posts and fasten together with (4) 3/4" White Self-Drilling Stainless Steel Screws (J).

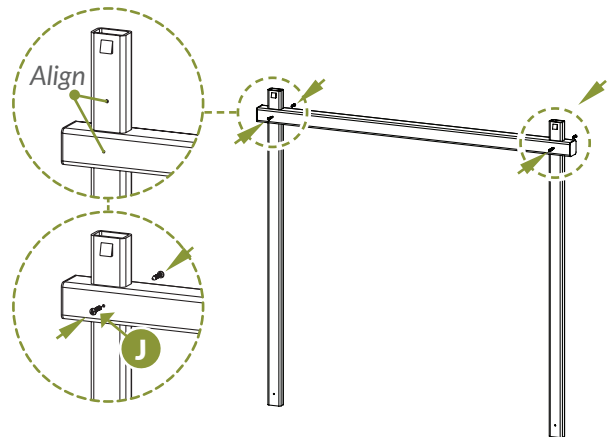

STEP 4.3 ▶

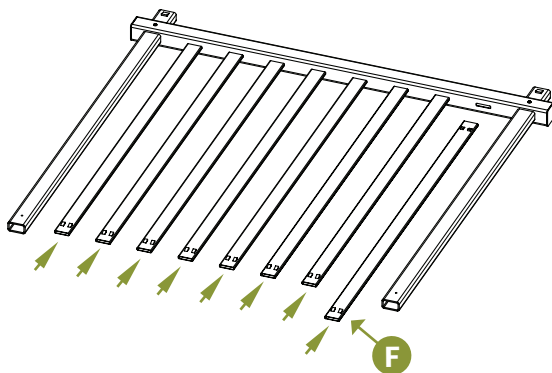

- Insert (8) Pickets (F) into the routed holes in the gate rail until they click into place.

STEP 4.4 ▶

- Slide the second gate rail over the gate posts and pickets until the pre-drilled holes in the posts and rail align. The pickets will click into place. Fasten the gate rail to the gate posts using (4) 3/4" white self-drilling stainless steel screws.

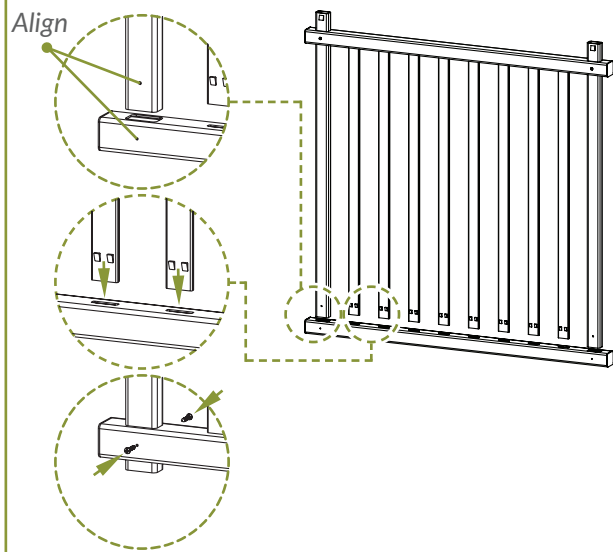

STEP 4.5

- Starting with one inside corner, place (1) L Bracket (**K**) against a gate rail and gate post as shown. Fasten the L bracket with (4) $\frac{3}{4}$ " white self-drilling stainless steel screws. Repeat for the three remaining inside corners.

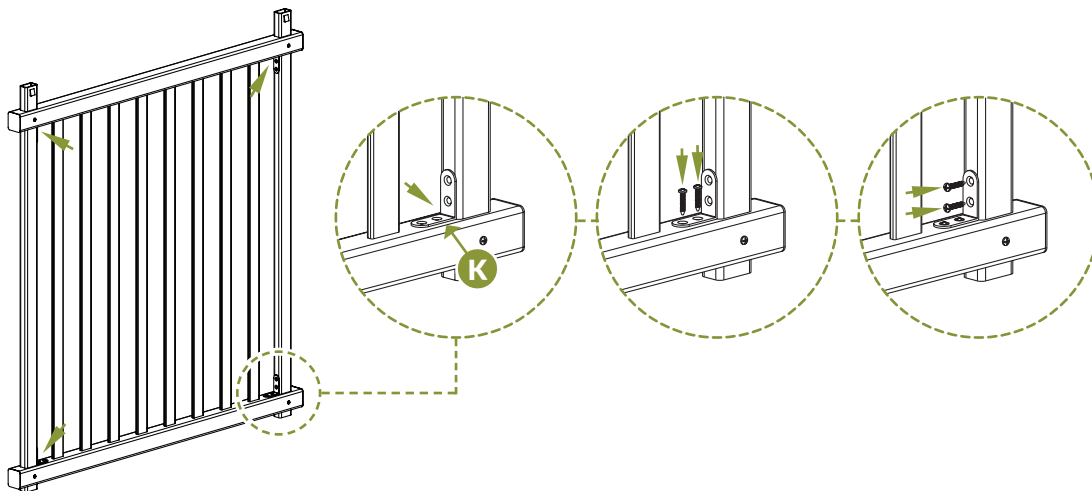
**STEP 5: INSTALL POST CAPS, GATE HINGES, AND GATE LATCH****STEP 5.1**

- Pressure fit (2) Post Caps (**A**) over the gate posts. The post caps will lock into place.

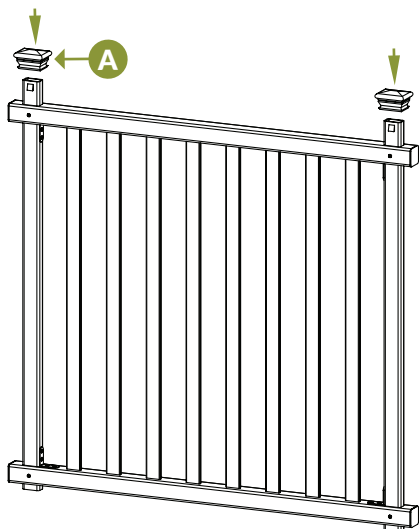
**STEP 5.2**

- Pre-drill two holes on the face of the gate rails for each Gate Hinge (**G**) with the $\frac{1}{16}$ " Drill Bit (**L**). Holes should be about $\frac{1}{4}$ " from the edge of the rail as shown. Fasten each gate hinge with (2) $\frac{1}{2}$ " Black Self-Tapping Steel Screws (**I**).

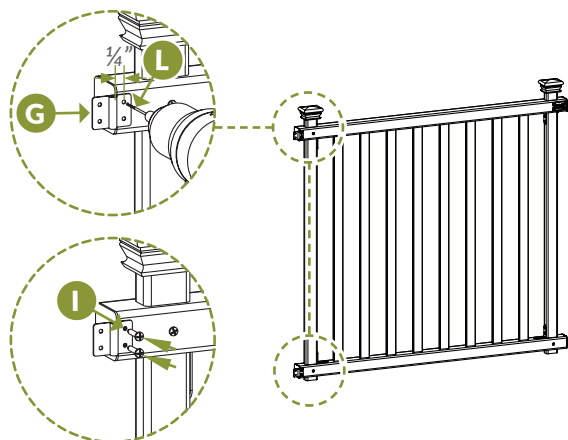

STEP 5.3

► Align the Gate Latch (**H**) with the top of the top gate rail and pre-drill four holes with the $\frac{1}{16}$ " drill bit. Fasten with (4) $\frac{1}{2}$ " black self-tapping steel screws.

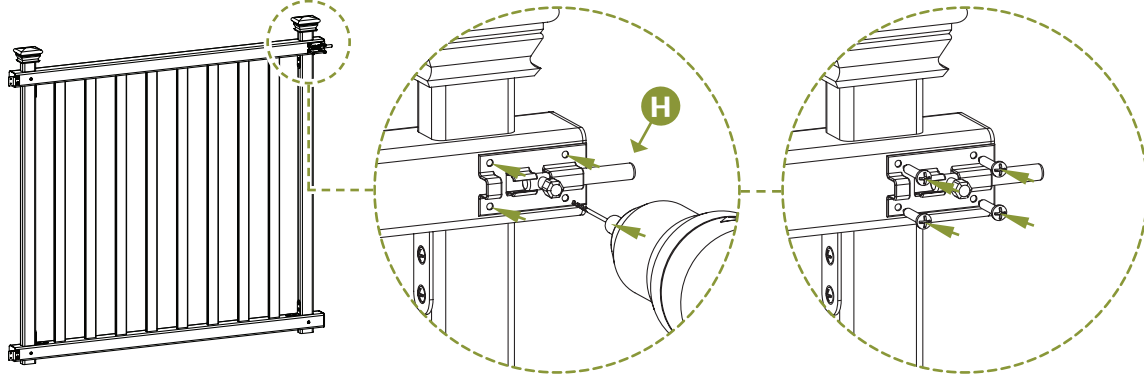
**STEP 6: ASSEMBLE GATE WINGS****STEP 6.1**

► Orient (2) Posts (**C**) so the tabs are facing up as illustrated. Insert the posts down through (2) Rails (**B**). Align the pre-drilled holes in the rails with the pre-drilled holes in the posts.

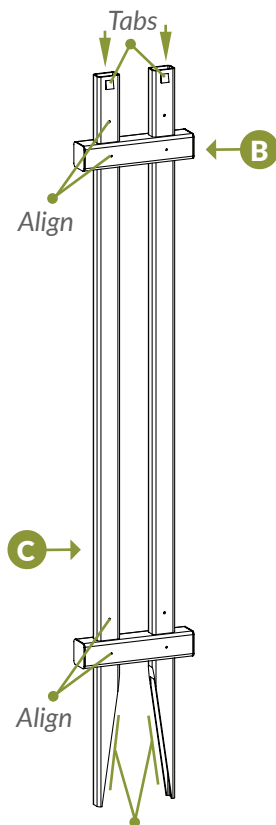

Note: Orient the posts as illustrated

STEP 6.2

► Fasten the posts and rails together with (8) $\frac{3}{4}$ " white self-drilling stainless steel screws. Repeat for the second gate wing.

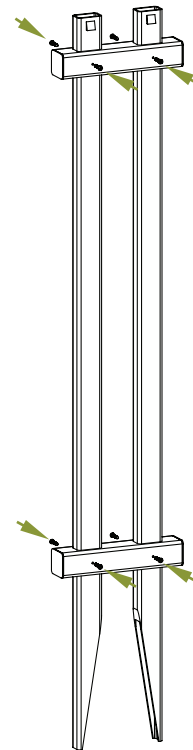

STEP 7: INSTALL GATE WINGS INTO THE GROUND

STEP 7.1

- Move the gate wings to their final location and mark the location of the posts. The posts should be $38\frac{11}{16}$ " apart (inside to inside) or $40\frac{3}{16}$ " apart (center to center).

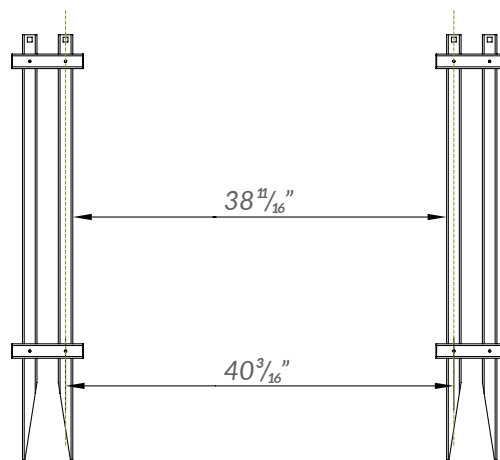
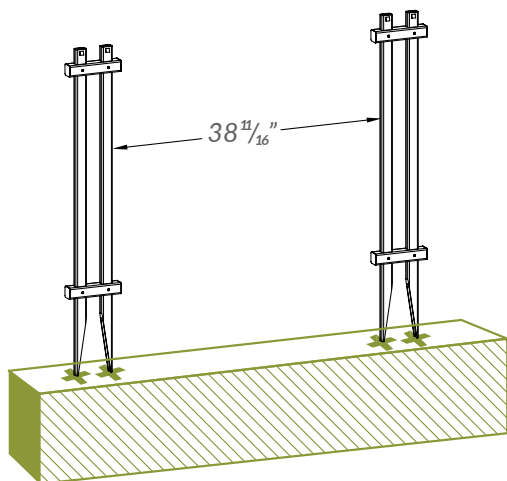

STEP 7.2

- Loosen the top 6" to 8" of the ground using a claw hammer (or something equivalent) as illustrated. Add water to loosen the soil if necessary.

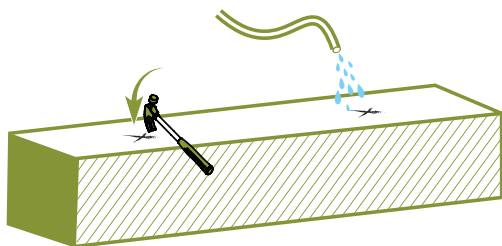

STEP 7.3

- Use a block of wood to protect the top of the posts, and gently hammer each gate wing equally into the ground until the bottom rails are about 2" above the ground.

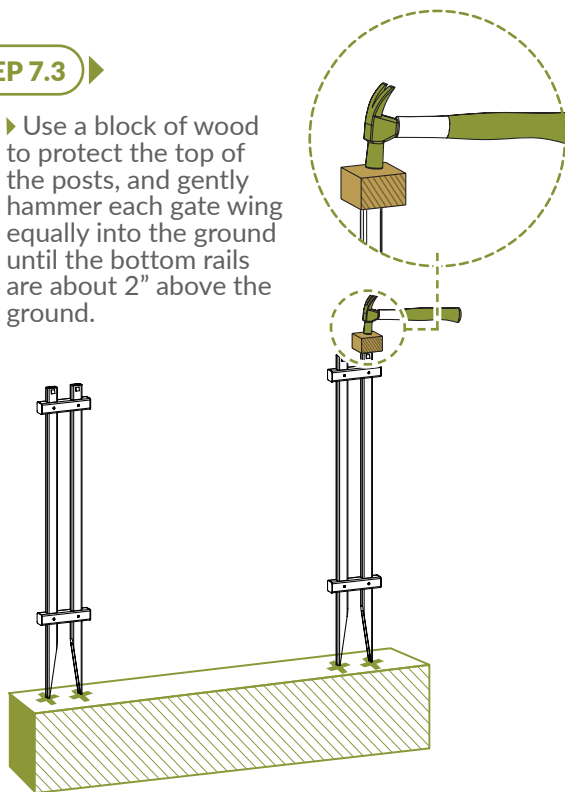

STEP 7.4 ▶

► **Optional in hard ground:** If your ground is too hard, or you have more than 3 or 4 panels to install, please consider these options:

1. Use a 1¼" diameter auger bit (commonly used for planting tulips) as illustrated (\$15-\$20 on Amazon.com).
2. Drill a hole about 12" to 16" deep at the desired location, and fill the holes with water as illustrated.
3. Push the fence wings into the holes.

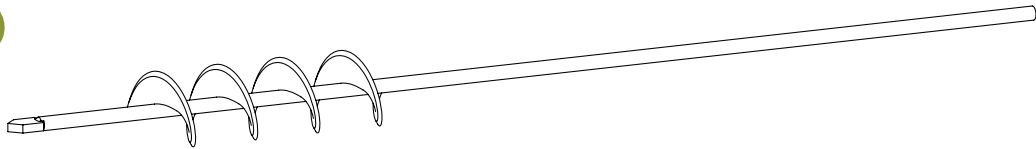
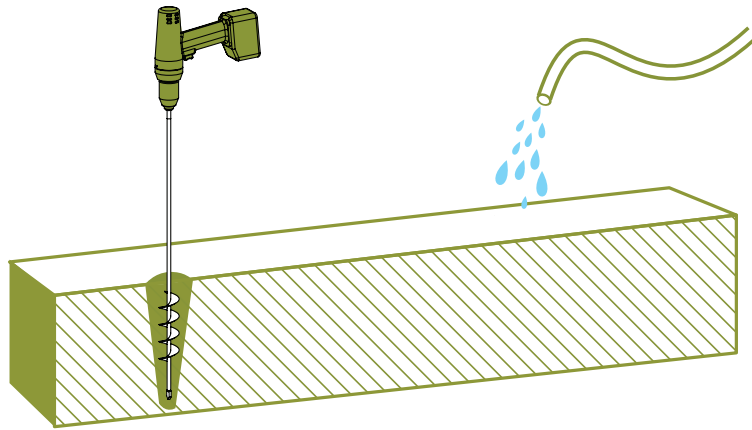
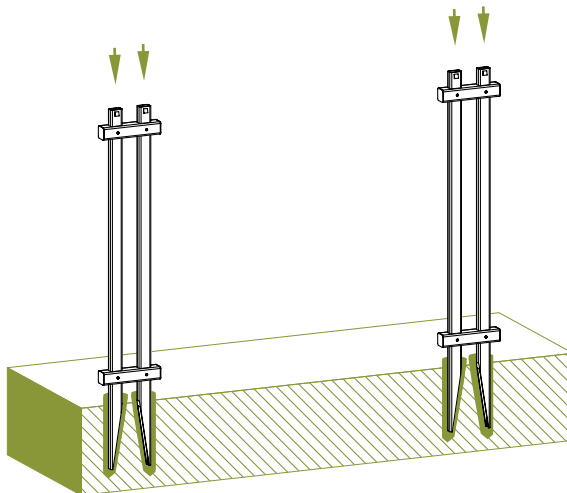
1**2****3**

STEP 7.5

- Level the assembled unit, backfill, and compact dirt around the base of each post to strengthen the unit.

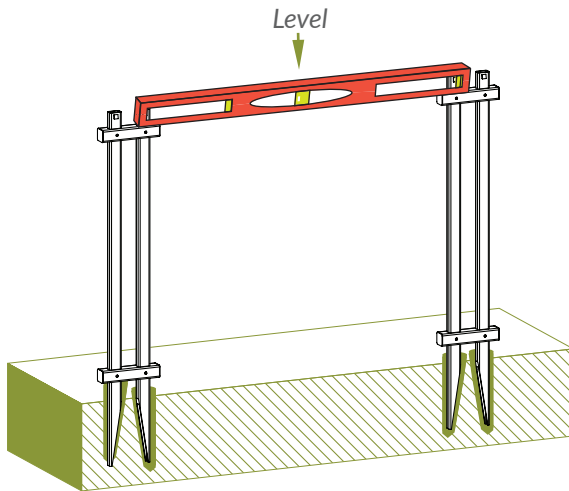
**STEP 7.6**

- Push the post caps down over the tops of the posts as illustrated. The post caps will lock into place.

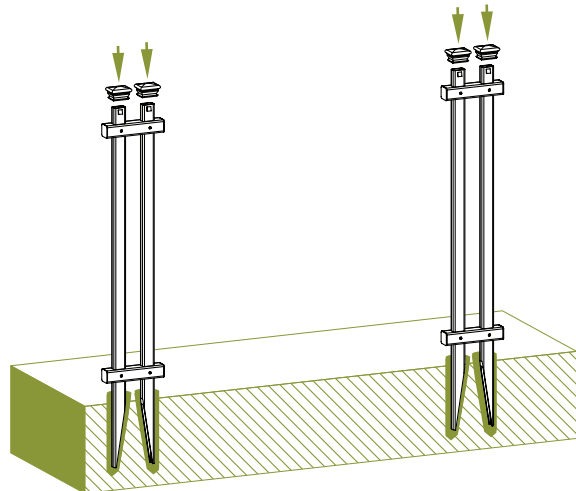
**STEP 8: INSTALL GATE****STEP 8.1**

- Align the gate hinges with the rails as illustrated. Mark and pre-drill two holes for each hinge with the $\frac{1}{16}$ " drill bit and fasten both hinges with (4) $\frac{1}{2}$ " black self-tapping steel screws.

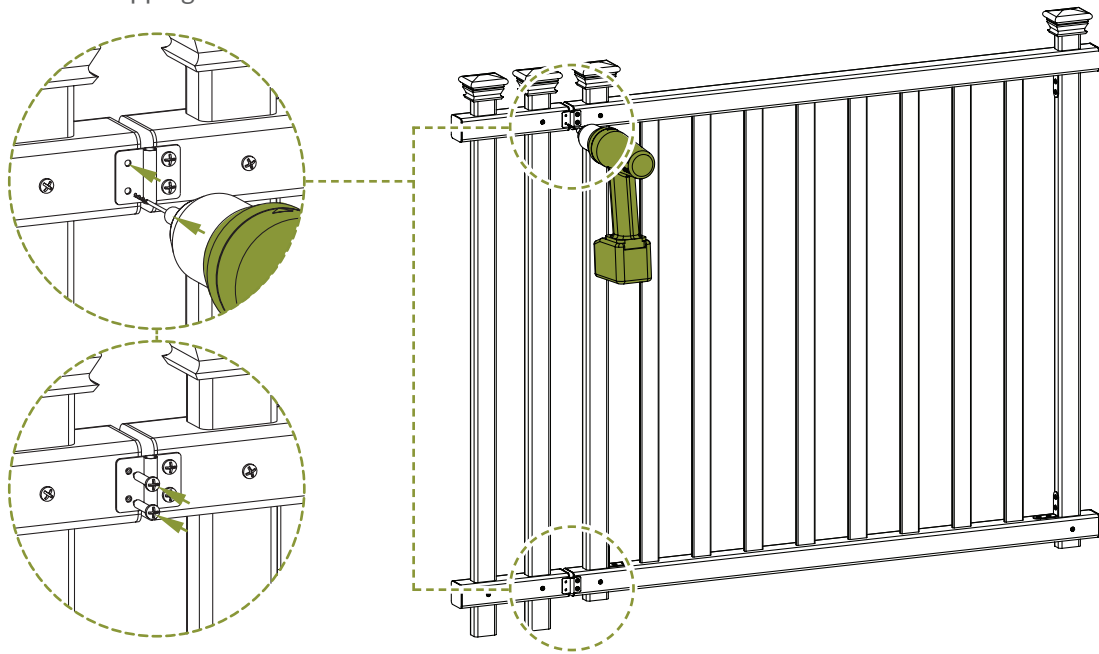

STEP 8.2 ▶

▶ Align the catch with the gate latch as shown and pre-drill two more holes into the gate wing rail. Fasten with (2) ½" black self-tapping steel screws to secure the latch catch.

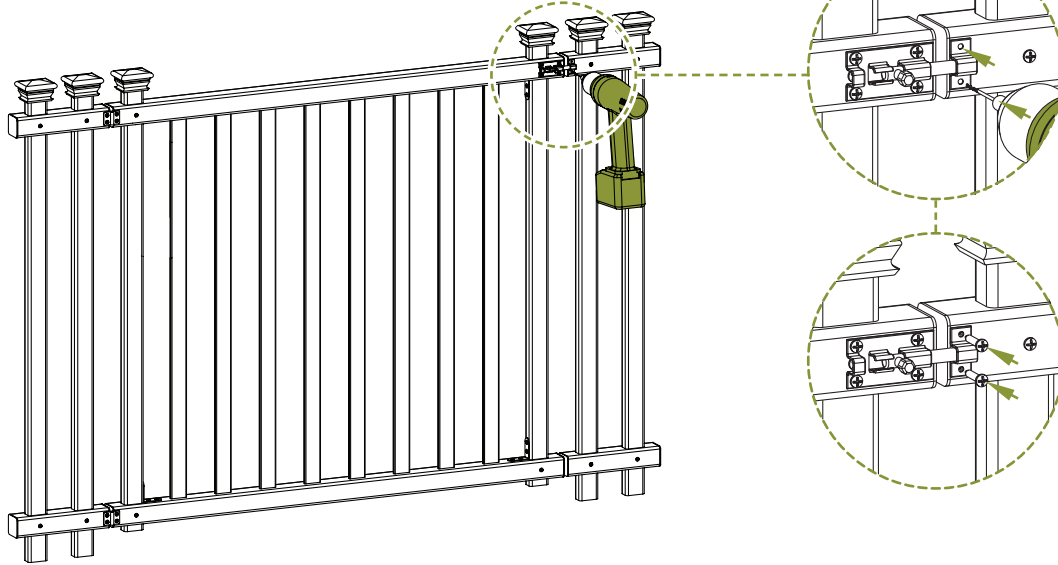
**STEP 9: INSTALL FENCE PANELS****STEP 9.1** ▶

▶ Follow the instructions included in your Baskenridge Fence Kit (ZP19037). Use the joiner clips provided in the fence kit to attach the gate to the fence.

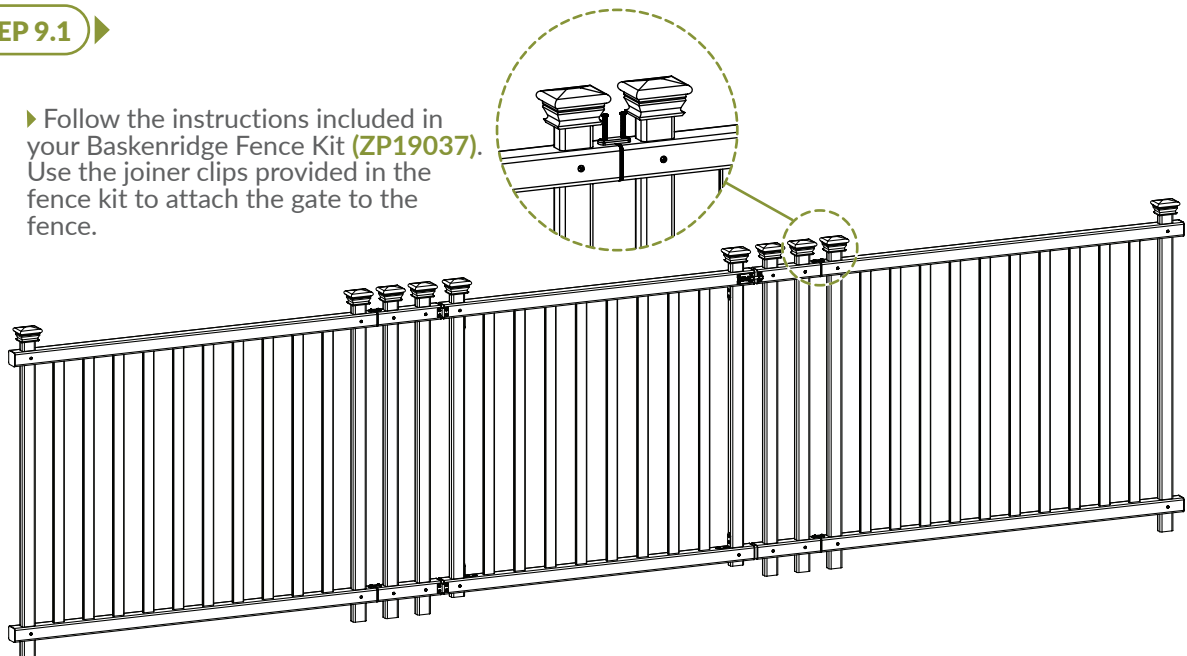



ZIPPITY

Easy Does It!



6935 Reames Rd. Ste. K.
Charlotte, NC 28216



support@zippity-outdoor.com

704-892-5222
877-234-6196



WWW.ZIPPITY-OUTDOOR.COM