



ZIPPITY

Easy Does It!

MAJESTIC MAILBOX KIT WITH PLANTER BOX

ASSEMBLY INSTRUCTIONS ZP19027

45 MIN

Approximate assembly time

Want to see a video on how to
assemble this product?
Scan the QR code

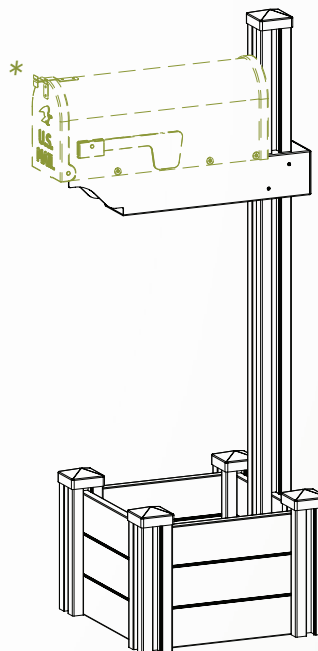

* Mailbox and mounting
hardware not included.

GENERAL INFORMATION



IMPORTANT

- + Check the inside of the larger pieces in your box for other materials packed inside.
- + When assembling components, place on a non-abrasive surface (i.e. shipping box) to avoid scratching.
- + We recommend an area approximately 5'x 8' for unobstructed assembling.
- + You should not need to use excessive force when assembling components.

MISSING OR DAMAGED PARTS?

VISIT OUR WEBSITE FIRST, SO WE CAN HELP YOU RIGHT AWAY!

Although great care has been taken to ensure proper packaging and handling of this product, occasionally problems occur. If you discover any missing, damaged, or defective parts, please visit our website to order replacement parts. If you experience any further trouble with your product, please contact our customer service department.

 parts.nychbrands.com

 support@zippity-outdoor.com

 **704-892-5222 / 877-234-6196**

Customer service agents are available to take calls weekdays from 9am-5pm EST. If you call outside of business hours, please leave a voicemail.

To help you quickly and accurately, please have reference item number **ZP19027** and the specific part name which can be found on page 4. It is helpful if you can provide the batch lot which is a stamped number on the inside of the box.

NEED ASSEMBLY HELP?

If you are having problems with the assembly or installation of this product, we are happy to assist you with the process, **so please give us a call at 704-892-5222 / 877-234-6196.**

NEED TO RETURN?

If for some reason you need to return this product, please allow us to help resolve your issues first. If you still decide to return the product, **you will need to initiate the return from the company you originally purchased from.**

Detailed Product Dimensions & Specifications

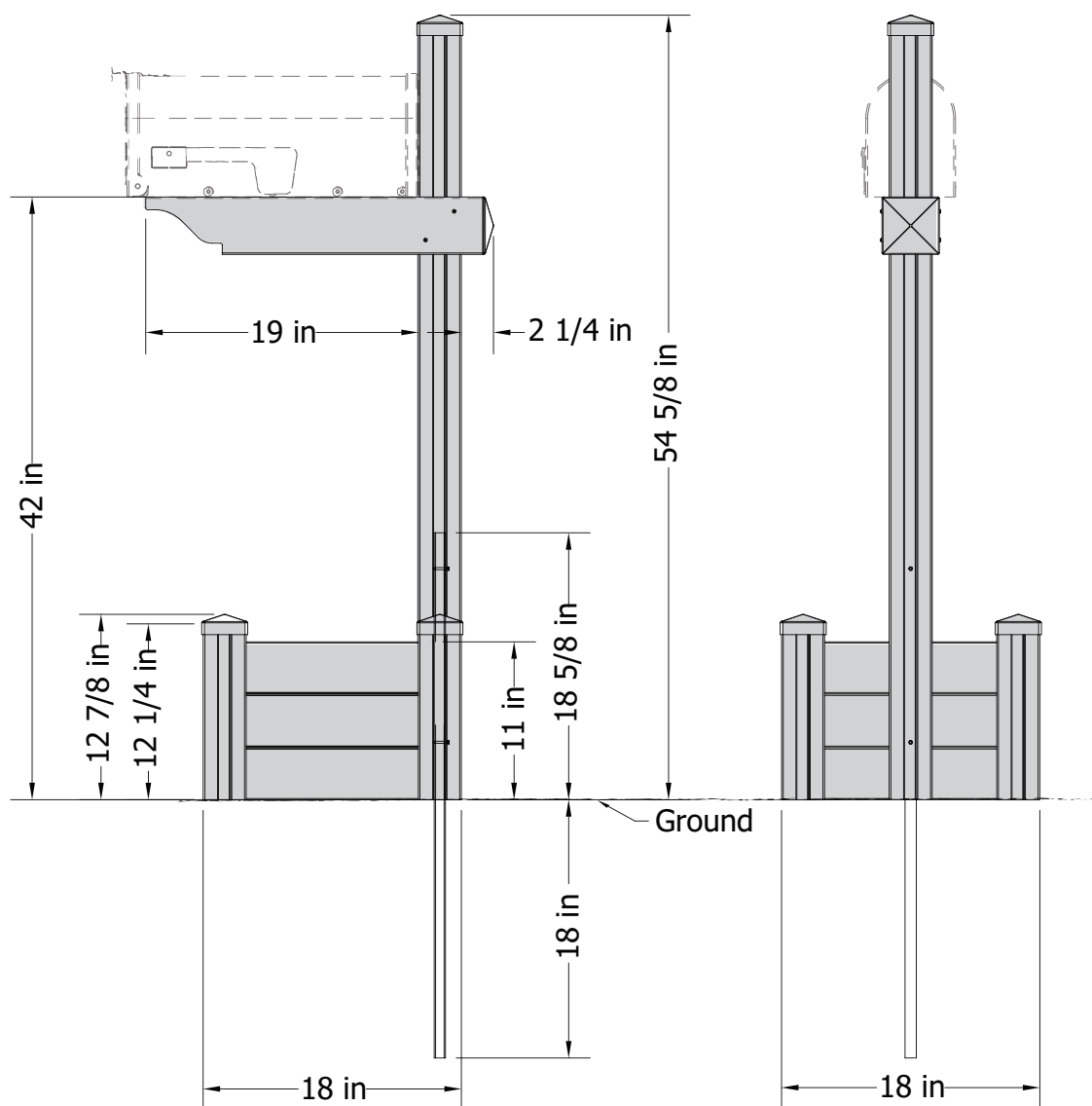

STEP 1: LAY OUT MATERIALS

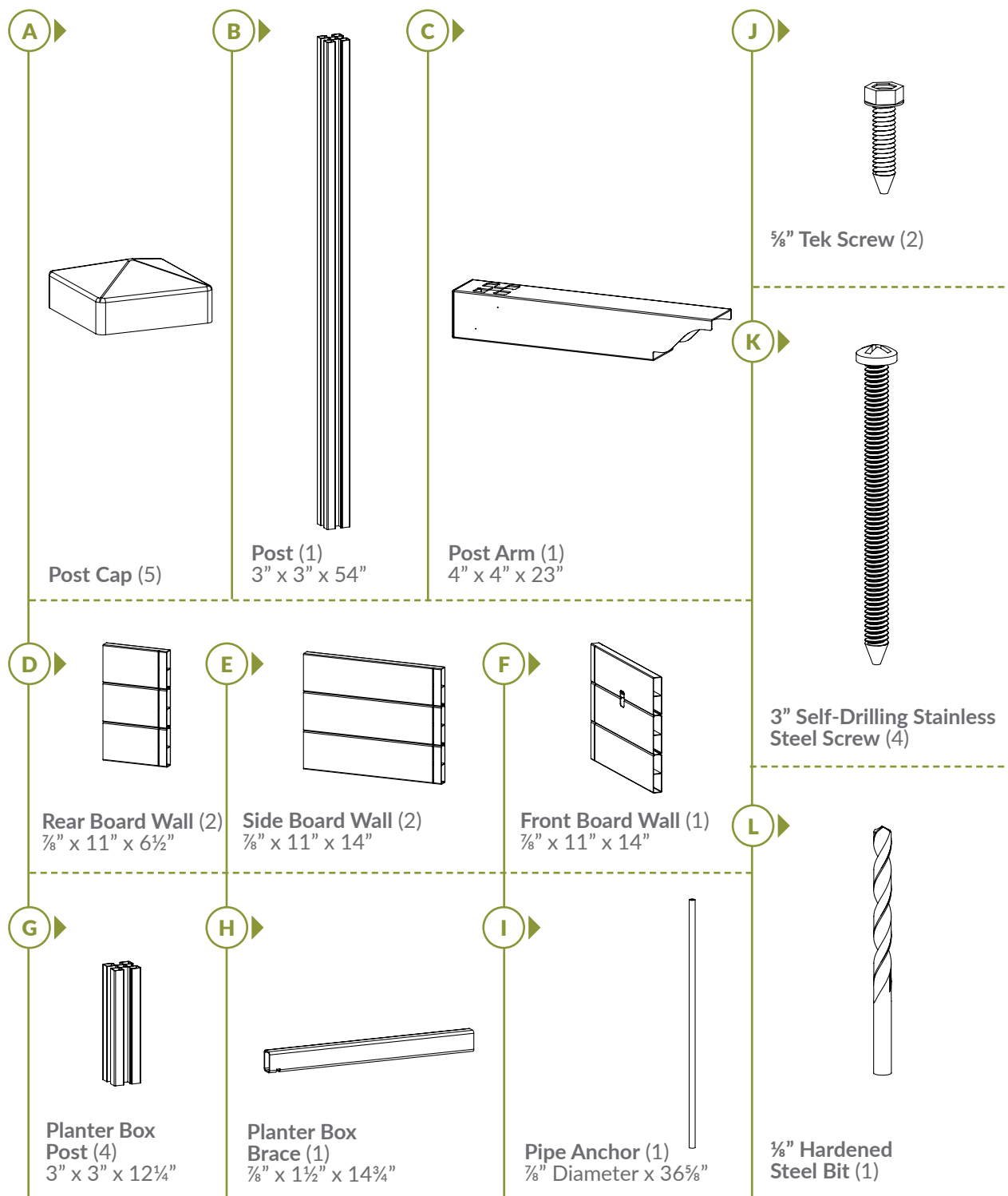

STEP 2: ASSEMBLE PLANTER BOX

STEP 2.1

- Slide the Planter Box Brace (H) down the Post (B) as shown. Note the location of the notch on the planter box brace.

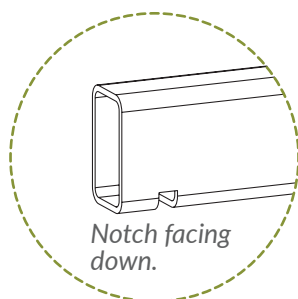

STEP 2.2

- Insert the planter box brace into the routed hole in the Front Board Wall (F). The planter box brace will lock into place.

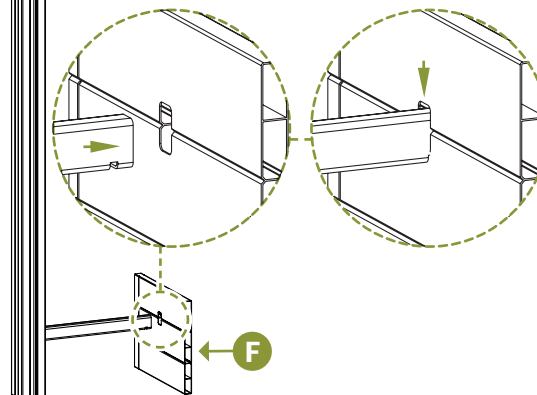

STEP 2.3

- Slide (2) Planter Box Posts (G) down over each end of the front board wall.

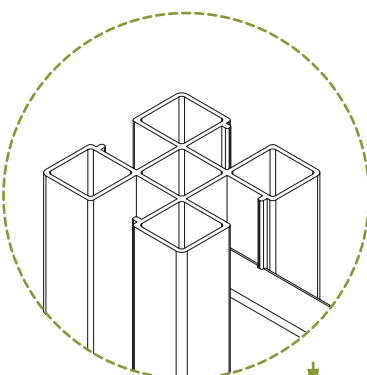

Note: The groove in the planter box posts fit inside the notch on the front board wall.

STEP 2.4

- Slide (2) Side Board Walls (E) down into place as shown.

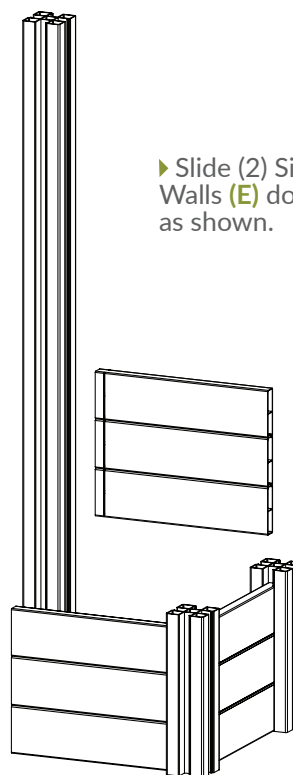

STEP 2.5

► Slide (2) planter box posts over the side board walls as shown.

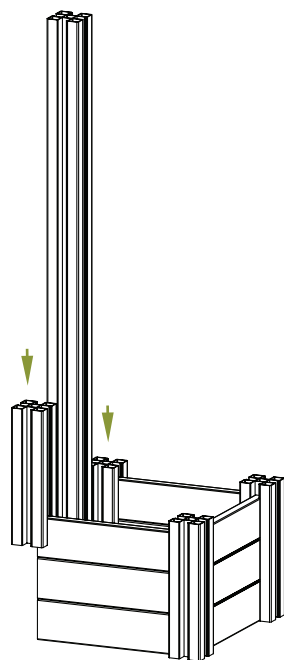
**STEP 2.6**

► Slide the Rear Board Walls (D) down into place as illustrated.

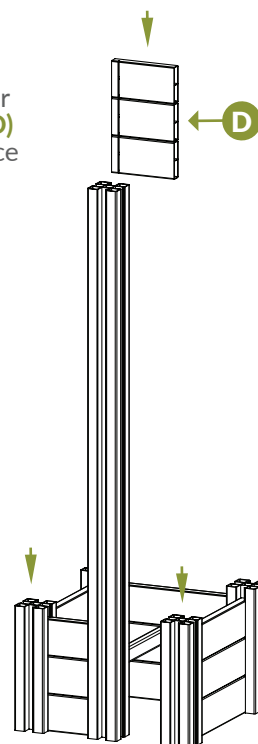
**STEP 3: INSTALL PIPE ANCHOR****STEP 3.1**

► Locate where you would like the post to be installed. Using a sledge hammer, drive the Pipe Anchor (I) approximately 18" into the ground (18 5/8" above the ground).

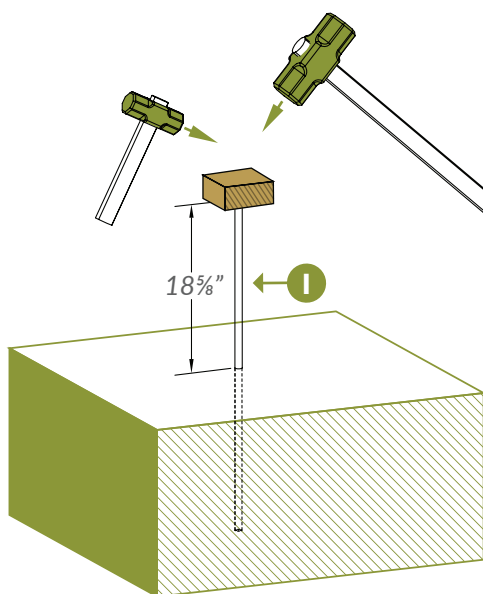

Note: Check if the pipe anchor is level in both directions at about 6" intervals as you pound it into the ground. Usually, after it is about 12" into the ground, the trajectory is established, and you can no longer level the Pipe Anchor.



10lb Sledgehammer



5lb Sledgehammer



Hammer

STEP 3.2

- With a helper, carefully lift the assembled unit, and place the post over the pipe anchor.

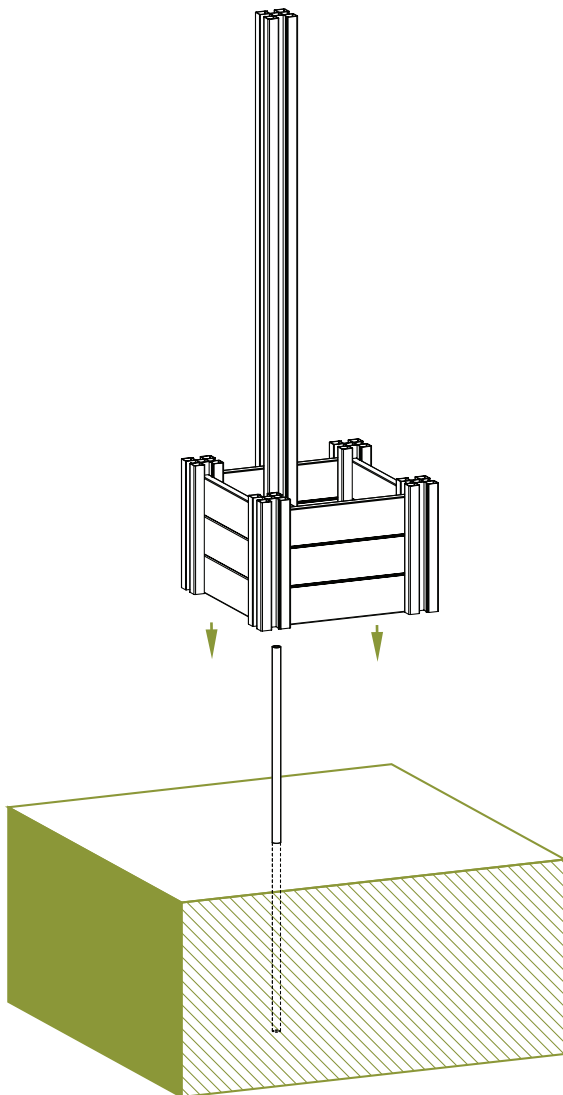
**STEP 3.3**

- With the 1/4" Hardened Steel Drill Bit (L), pre-drill (2) holes through the post and pipe anchor as shown. The holes should be approximately 4" and 16" above the ground and centered on the groove of the post. Fasten with (2) 5/8" Tek Screws (J).

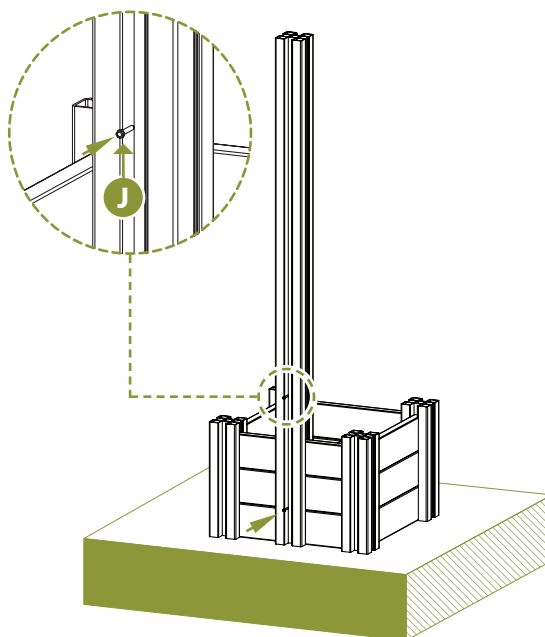
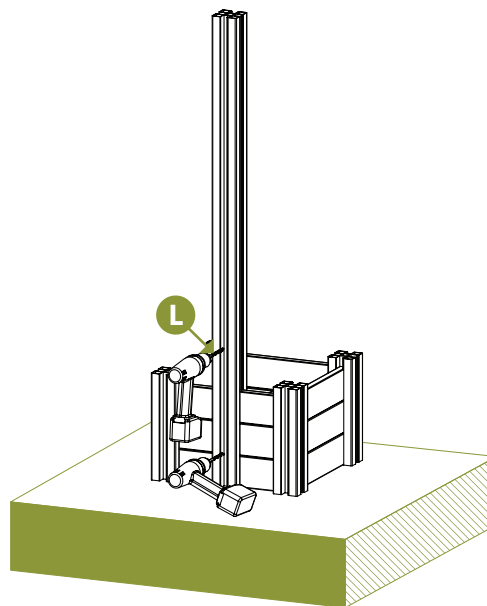

STEP 4: INSTALL POST ARM

STEP 4.1

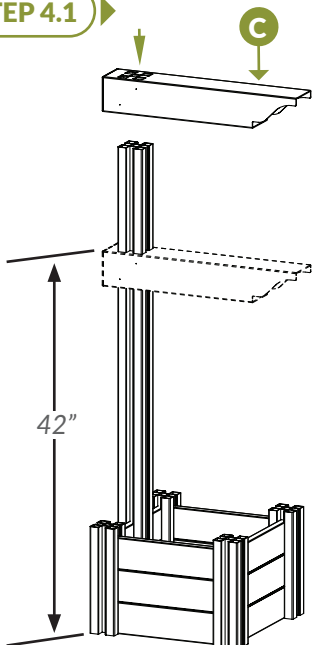

► Slide the Post Arm (C) down over the post as shown. The top of the post arm should be about 42" above the ground.

STEP 4.2

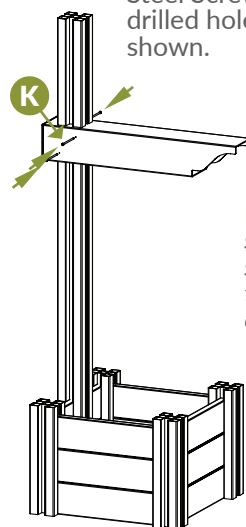

► Drive (4) 3" Self-Drilling Stainless Steel Screws (K) through the pre-drilled holes on the post arm as shown.

Note: Slightly angle the 2½" self-drilling stainless steel screws on one side to keep them from running into each other inside the post.

STEP 5: INSTALL POST CAPS

STEP 5.1

► Pressure fit the Post Caps (A) into place as shown. You can secure the post caps more permanently using PVC glue if necessary.

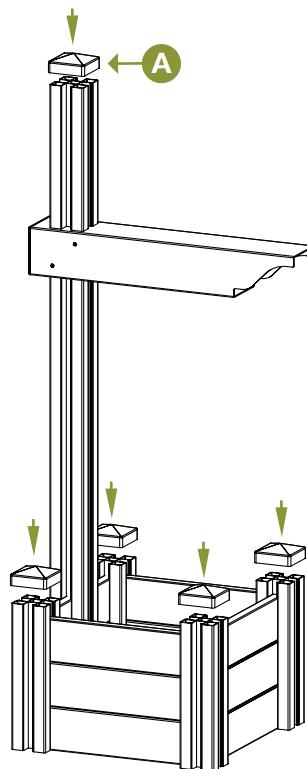



ZIPPITY

Easy Does It!



6935 Reames Rd. Ste. K.
Charlotte, NC 28216



support@zippity-outdoor.com

704-892-5222
877-234-6196



WWW.ZIPPITY-OUTDOOR.COM